

## Specifications

Width: 10.00m

Minimum Length: 3.00m

Extension (unlimited): 3.00m

Side height: 2.30m

Peak height: 4.11m

Bay distance: 3.00m

Wind load: 100 km/h

Structure: European – hard pressed extruded structural aluminium

Main profile Size: 94 / 48 / 3 mm (4 Channel)

Connection components: European – hot dipped, structural grade corrosive resistant galvanised steel

Covering: Robust industrial grade PVC, 650g/m<sup>2</sup> coated polyester fabric. Flame retardant according to DIN 4102 B1, M2

Walling system: Sandwich panels made from galvanised steel with polyurethane foam as core. Thickness: 40 mm, k-value: 0,5 W/ m<sup>2</sup>K. Colour: outside olive-green (RAL 6031) / inside white

## Packaging Dimensions

Standard Tent (6.00m x 9.00m)

Longest part: 2.70m

Weight (approx.): 2,754.00 kg

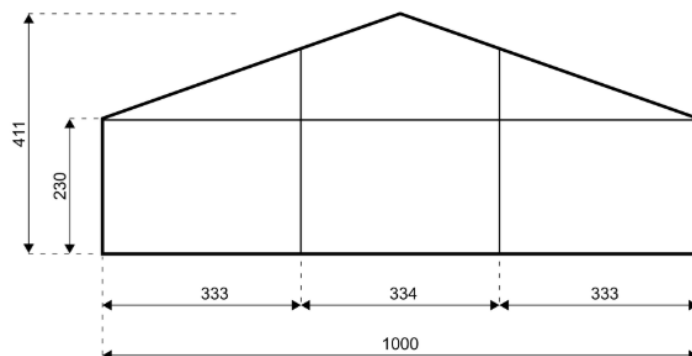
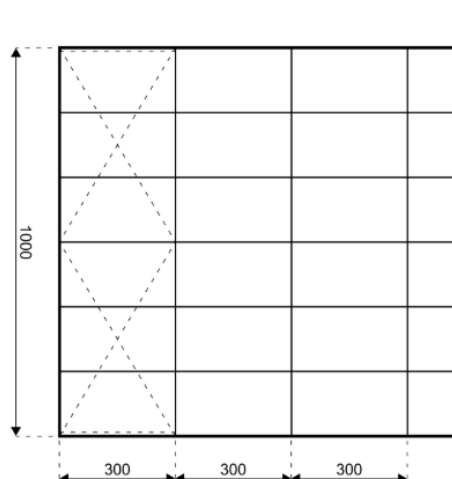



## STRUCTURE FEATURES

- Frame made from extruded 4-channel-Profiles
- Galvanised steel plate eave and ridge connector
- Each front and rear bay with 2 gable uprights
- Base plates made from Steel – S235
- Purlins made from extruded Aluminium profiles
- Including set up equipment
- Ground anchors made from steel, galvanised



## COVER FEATURES

- Usable from both sides
- One door on each gable side/ end field (1.20 m x 2.10 m)
- Roof cover with windows on both sides and in the central position, each window with welded mosquito netting, transparent flap and outer flap
- Pipelines for HVAC and cables systems
- Mudflap fixed at covers end
- Mudflap made from PVC, same colour as the roof cover
- High frequency welded
- Waterproof
- Putrefaction-restraining (anti-fungicidal)
- Bar tensioned
- Pack bags for each cover part of the tent, bags made of PVC Material

## COVER SPEC

- Type of coating: PVC
- Finish: UV-protected
- Standard colour outside: olive-green – RAL 6031
- Standard colour inside: White
- High-quality PVC: 650 gr/ sqm – EN ISO 2286-2
- Tensile strength – warp/ weft: 2500 / 2500 N/5cm – EN ISO 1421/V1
- Tear resistance – warp/ weft: 250 N / 250 N – DIN 53363
- Adhesion: 20 N/cm – PA 09.03
- Cold resistance: – 40 °C – EN 1876-1
- High Temperature: +70 °C – PA 07.04
- Light fastness: >6 Note, Value – EN ISO 105 B02
- Crack resistance: 100000 x – DIN 53359 A
- Yarn count: 1100 dtex – ISO 2060
- Flame retardant according to BS 7837, California T 19, D.M. 26.06.84 (UNI9177): CL. 2, DIN 4102: B1, NFP 92507: M2, NFPA 701 Test 2, EN 13501-1: B-s2-d0

## ACCESSORIES

In order to ensure your military or humanitarian shelter is customised to your exact requirements we provide a complete range of premium accessories and military camp equipment.

These include sunshades, insulating liners and foil sheeting, solid walling, flooring systems, air conditioning, ventilation, heating and electrical equipment.

We do also supply complete turnkey solutions which are provided with all services and military camp equipment needed for a fully functional humanitarian or military camp.

## TYPES OF ACCESSORIES

- Sunshade cover and insulation liners for better climate inside the tent
- Different types of flooring systems available
- Electrical equipment (Distribution boxes, lighting systems, cables...)
- Heating, ventilation, air conditioning - System (HVAC)
- Complete camp solution, including supply, installation, maintenance and much more

